

# VINdustry Wine Pegs & Panel Kits

## Rectangular panel LED light and stand-off plywood installation

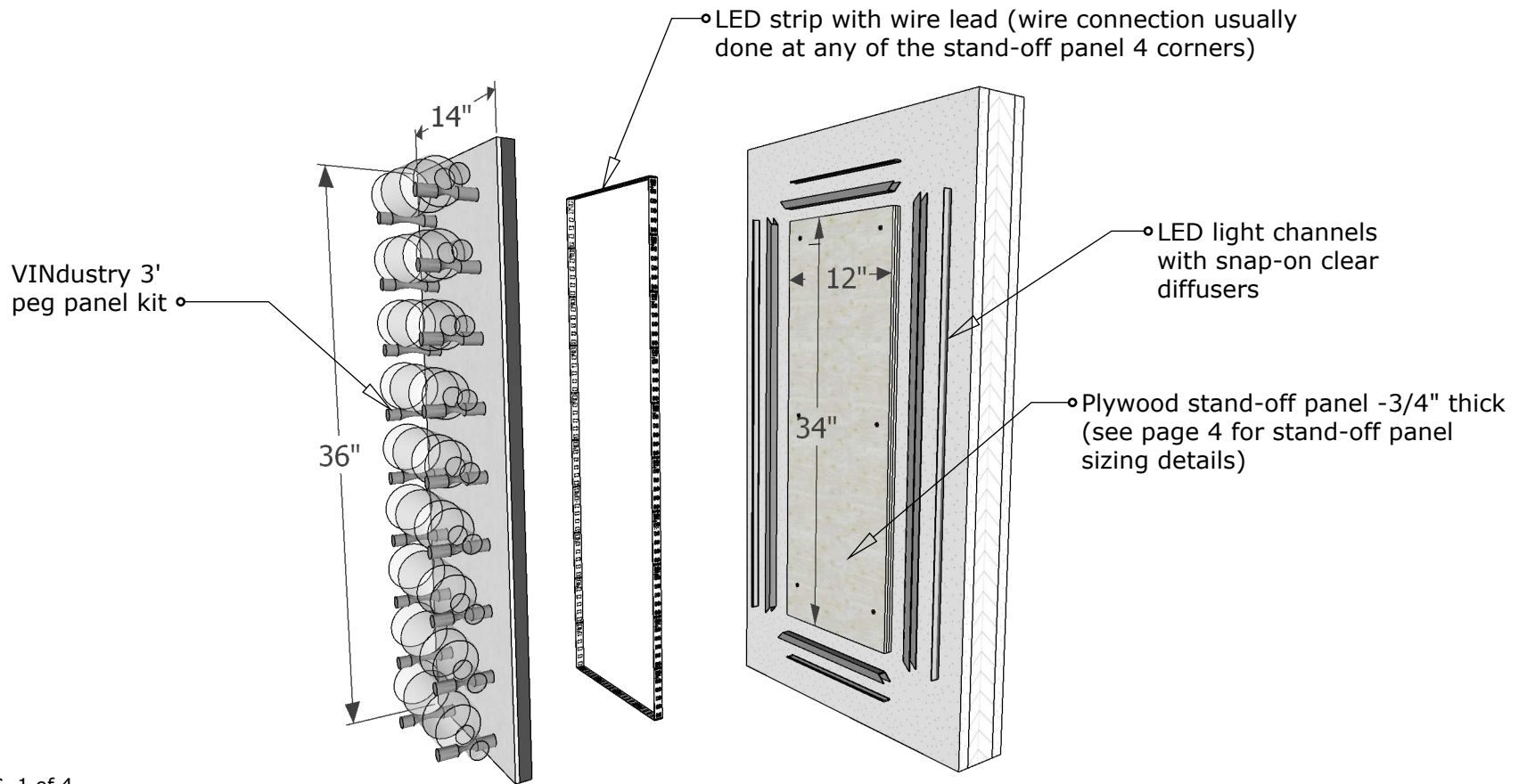

# VINdustry Wine Pegs & Panel Kits

## *Rectangular panel LED light and stand-off plywood installation*

### Step 1

Install pre-cut plywood panel,  
use a level to ensure level  
installation  
Plywood should be  
screwed to wall studs or using  
appropriate anchors/screws

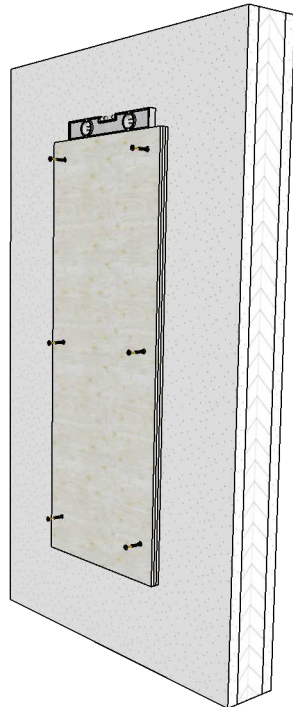

### Step 2

Cut LED channels to size and  
glue to 4 plywood edges using  
instant glue or double sided tape

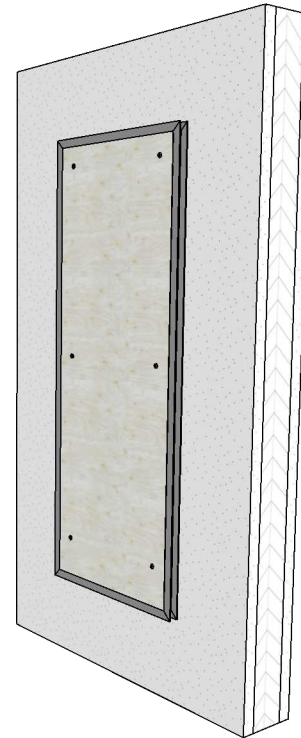

# VINdustry Wine Pegs & Panel Kits

## Rectangular panel LED light and stand-off plywood installation

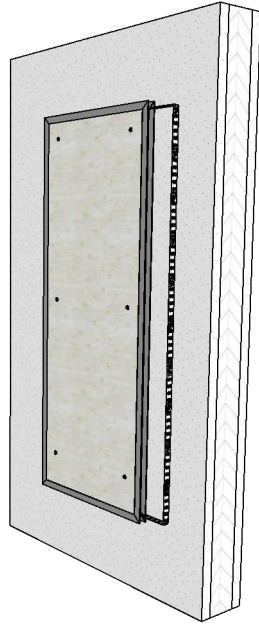

### Step 3

Connect wire lead to LED driver's wires, LED strips come with adhesive, glue carefully all around the bottom of channels in a continuous run

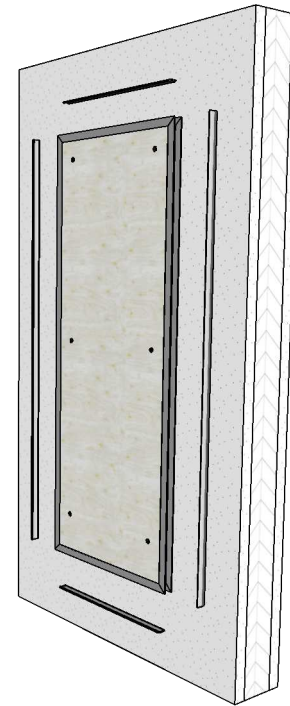

### Step 4

Cut clear diffusers to size and snap into installed channels

### Step 5

Install VINdustry rectangular peg panel  
(Follow peg panel's installation instructions)

# VINdustry Wine Pegs & Panel Kits

## Rectangular panel LED light and stand-off plywood installation

### 3' VINdustry panel

LED stand-off panel to be  
1" - 1 1/4" shorter on all  
sides than peg panel  
Length of LED strip required - 8'

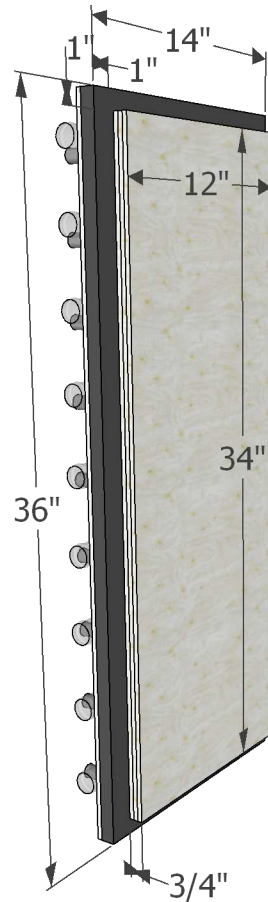

### 6' VINdustry panel (two 3' panels stacked)

LED stand-off panel to be  
1" - 1 1/4" shorter on all  
sides than peg panel  
Length of LED strip required - 14'

