

8_5-250-5025-3975

11 COLUMN COMPOUND DIAMOND BIN ASSEMBLY INSTRUCTIONS

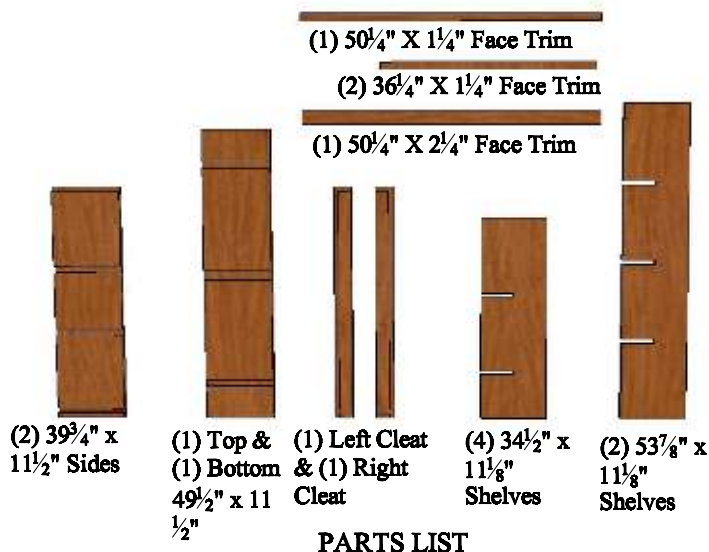

STEP 1.
ATTACH (2) SIDES TO THE TOP & BOTTOM
w/ SCREWS. ENSURE SLOTS ON SIDES
ALIGN.



STEP 2.
ATTACH (1) LEFT & (1) RIGHT CLEAT w/
SCREWS

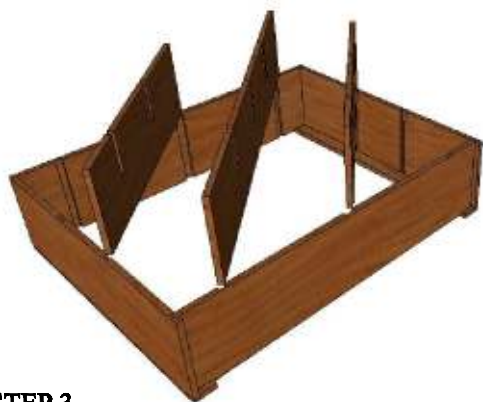

STEP 3.
FLIP BIN OVER. SLIDE (2) SHORT SHELVES,
SHORT SHELVES TO BE REVERSED FROM ONE
AN OTHER & (1) LONG SLELF INTO SLOTS AS
SHOWN. ENSURE SHELF NOTCHES FACE UP
AND ALIGN.



STEP 4.
SLIDE (2) SHORT SHELVES, SHORT SHELVES TO
BE REVERSED FROM EACH OTHER & (1) LONG
SLELF INTO SLOTS AS SHOWN. ENSURE SHELF
NOTCHES FACE DOWN.

8_5-250-5025-3975

11 COLUMN COMPOUND DIAMOND BIN ASSEMBLY INSTRUCTIONS



STEP 5.

ATTACH (1) $2\frac{1}{4}$ " x $50\frac{1}{2}$ " FACE TRIM TO
BOTTOM OF BIN, (1) $1\frac{1}{4}$ " x $50\frac{1}{2}$ " FACE
TRIM TO TOP OF BIN AND (2) $1\frac{1}{4}$ " x $36\frac{1}{4}$ "
FACE TRIMS TO SIDES w/ FINISH NAILS.