

10 COLUMN BASE COMPOUND  
DIAMOND BIN  
ASSEMBLY INSTRUCTIONS

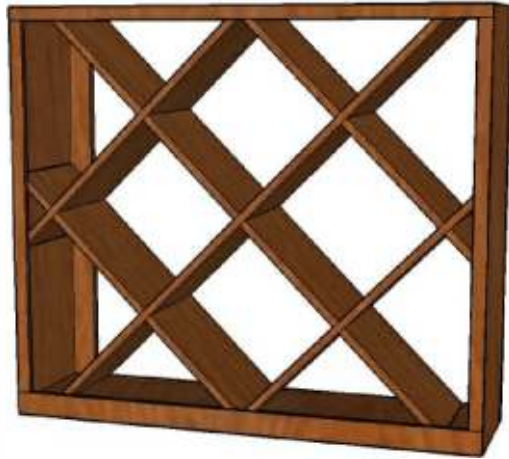

PARTS LIST

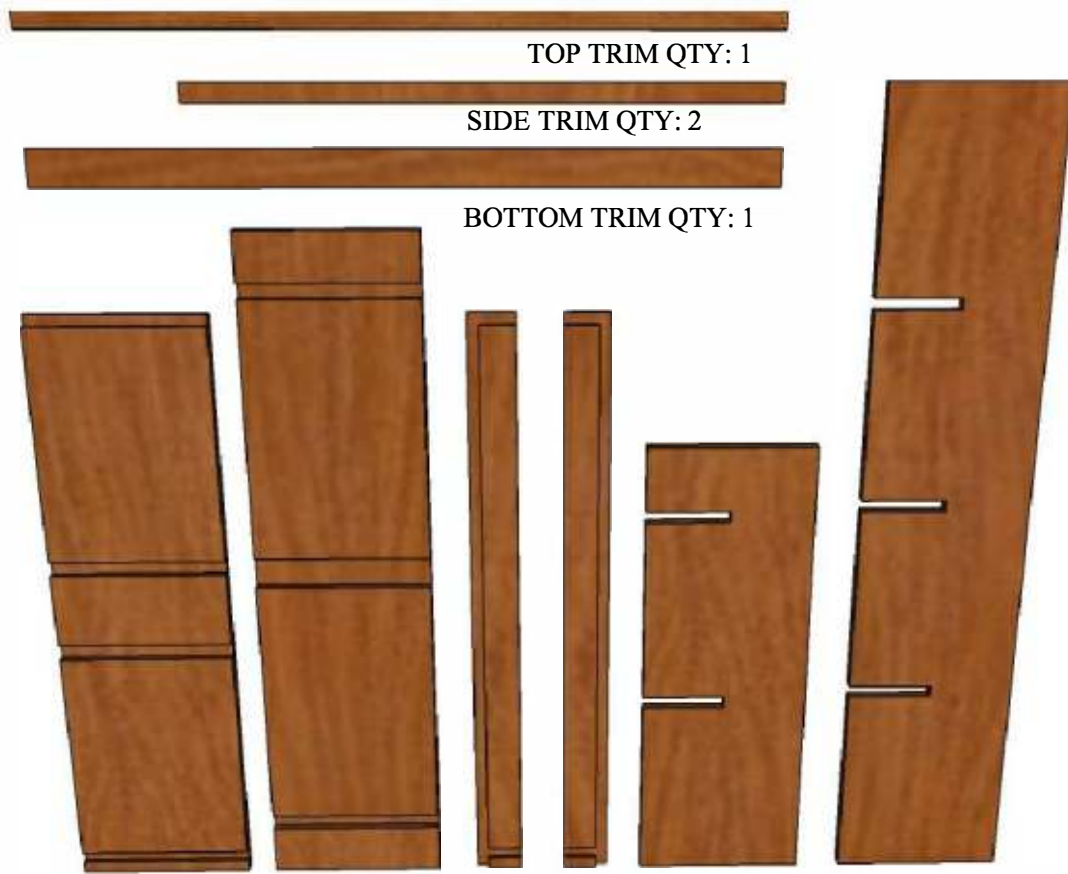

SIDE QTY: 2

TOP /  
BOTTOM  
QTY: 1 ea.

REAR  
CLEATS  
QTY: 1 LEFT,  
1 RIGHT

SHORT  
SHELF  
QTY: 4

LONG  
SHELF  
QTY: 2

10 COLUMN BASE COMPOUND  
DIAMOND BIN  
ASSEMBLY INSTRUCTIONS (cont.)



STEP 1.  
ATTACH TOP AND BOTTOM TO BOTH SIDES  
WITH (6) SCREWS AS SHOWN



STEP 2.  
ATTACH LEFT AND RIGHT CLEATS TO BACK  
OF BIN WITH GLUE AND SCREWS AS SHOWN

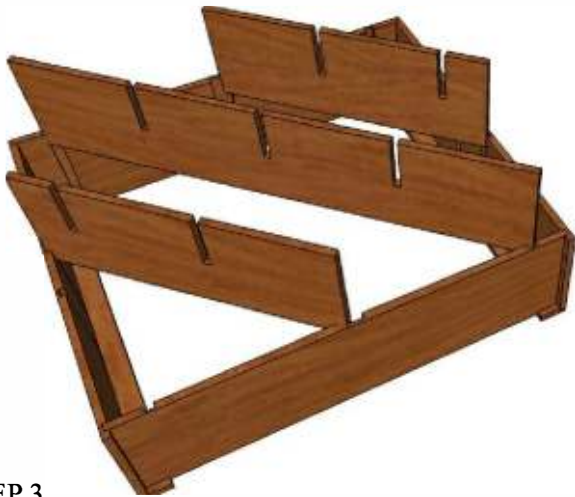

STEP 3.  
FLIP BIN OVER. LOCATE (1) LONG SHELF AND (2)  
SHORT SHELVES. SLIDE SHELVES INTO SLOTS AS  
SHOWN WITH SHELF NOTCHES FACING UPWARD.



STEP 4.  
LOCATE REMAINING (1) LONG SHELF AND (2) SHORT  
SHELVES. SLIDE SHELVES INTO SLOTS AS SHOWN  
WITH SHELF NOTCHES FACING DOWNWARD.

STEP 5.  
ATTACH FACE TRIM TO FRONT OF  
BIN W/ NAILS. SET BIN UPRIGHT.

