



MAX REVEAL WALL RAIL INSTALL INSTRUCTIONS

IMPORTANT! PLEASE NOTE THE FOLLOWING:

Check the Package Contents for missing or damaged items; also, when securing the racks please use the appropriate mounting fasteners. Contact Customer Service at 1-800-343-9463 for questions or concerns.

PACKAGE CONTENTS

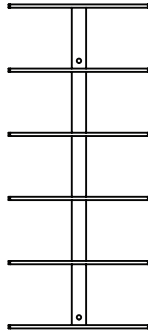

1 x Max Reveal Wall Rail



2-4 x Rail Dome Caps

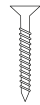

2-4 x Screws



2-4 x Drywall Anchors

RECOMMENDED INSTALLATION TOOLS (NOT INCLUDED)



Power Drill



Stud Finder

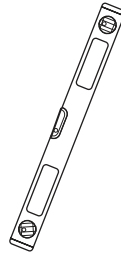

Level



Pencil



Tape Measure

RECOMMENDED FASTENER APPLICATIONS:

Drywall anchors (included) - Use for installing to drywall if studs are not present in the desired location. Do not use drywall anchors to secure into a wall stud location.

Wood Screws (included) - Use wood screws to secure wall studs or wood panels, do not use on drywall without securing to a stud.

Concrete, Brick or Stucco (Not Included) - 3/16" x 1 1/4" Masonry Screw or #8x1 1/4" screw with the proper concrete anchors.

**SCAN THE QR CODE TO
WATCH OUR MAX REVEAL
INSTALLATION VIDEO**



Scan Me

INSTALLATION INSTRUCTIONS

ULTRA™

STEP 01 IDENTIFY DESIRED MOUNTING LOCATION.

Use a stud finder to locate and mark stud positions. Hold the rack in the desired installation location.
REQUIRED CLEARANCE: Standard-Champagne bottles: 2" from walls/obstructions, 4" between racks

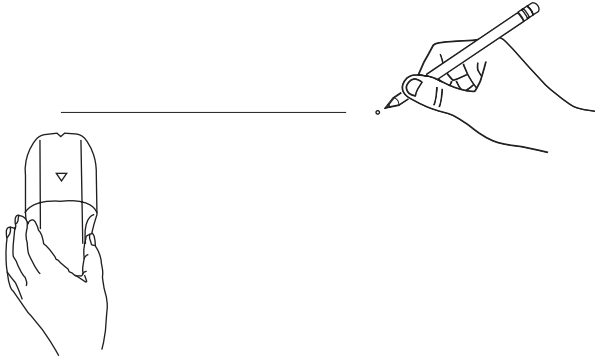

STEP 03 SELECT RACK'S MOUNTING HARDWARE

Choose hardware appropriate for your wall surface (drywall, stucco, concrete, or brick). Use provided drywall anchors when installing into drywall.

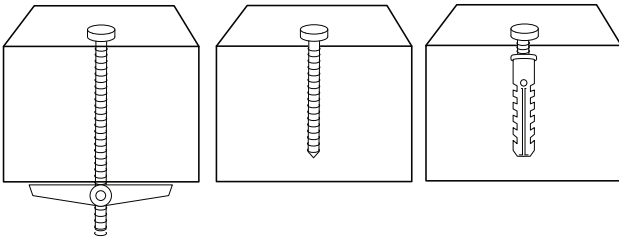

STEP 05 BEGIN TO MOUNT THE MAX REVEAL RACK.

Align the rack with marked holes. Secure it to the wall by installing screws into studs or anchors as applicable. Tighten until secure while ensuring the rack remains level.

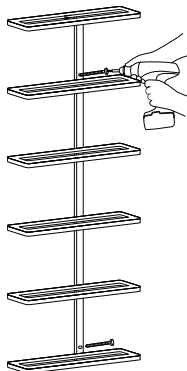

STEP 07 ADD WINE BOTTLES & ENJOY!

STEP 02 TEMPORARILY POSITION THE RAIL

Hold the rail in place and install one bottom screw only (no anchor) to support it. Once level, install remaining screws to mark holes, then remove them to install anchors.
IMPORTANT NOTE: Verify the racking is positioned so the dome caps will be hidden by the bottles once installed.

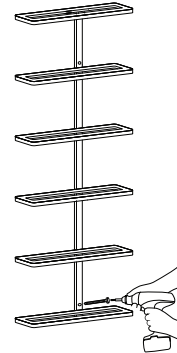

STEP 04 INSTALL THE PROVIDED DRYWALL ANCHORS

If mounting into drywall, position the self-drilling anchors at each marked location and drive them directly into the wall using a screwdriver or drill until they sit flush with the surface. Ensure all anchors are fully seated before proceeding.
IMPORTANT NOTE: Skip this step if mounting into studs or other materials.

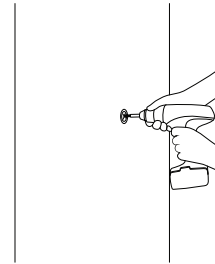

STEP 06 INSTALL THE PROVIDED DOME CAPS.

Press dome caps firmly into exposed mounting holes until fully seated.

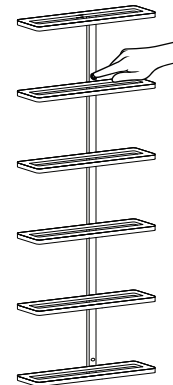

Show us your finished wine rack!
We'd love to see how your installation turned out.
Send photos or videos to: marketing@ultrawineracks.com
Your wine wall may be featured on our website or social media. By sending photos, you give Ultra Wine Racks permission to share them in our marketing.