

VINdustry Wine Pegs & Panel Kits

Rectangular panel Floating Shelves installation

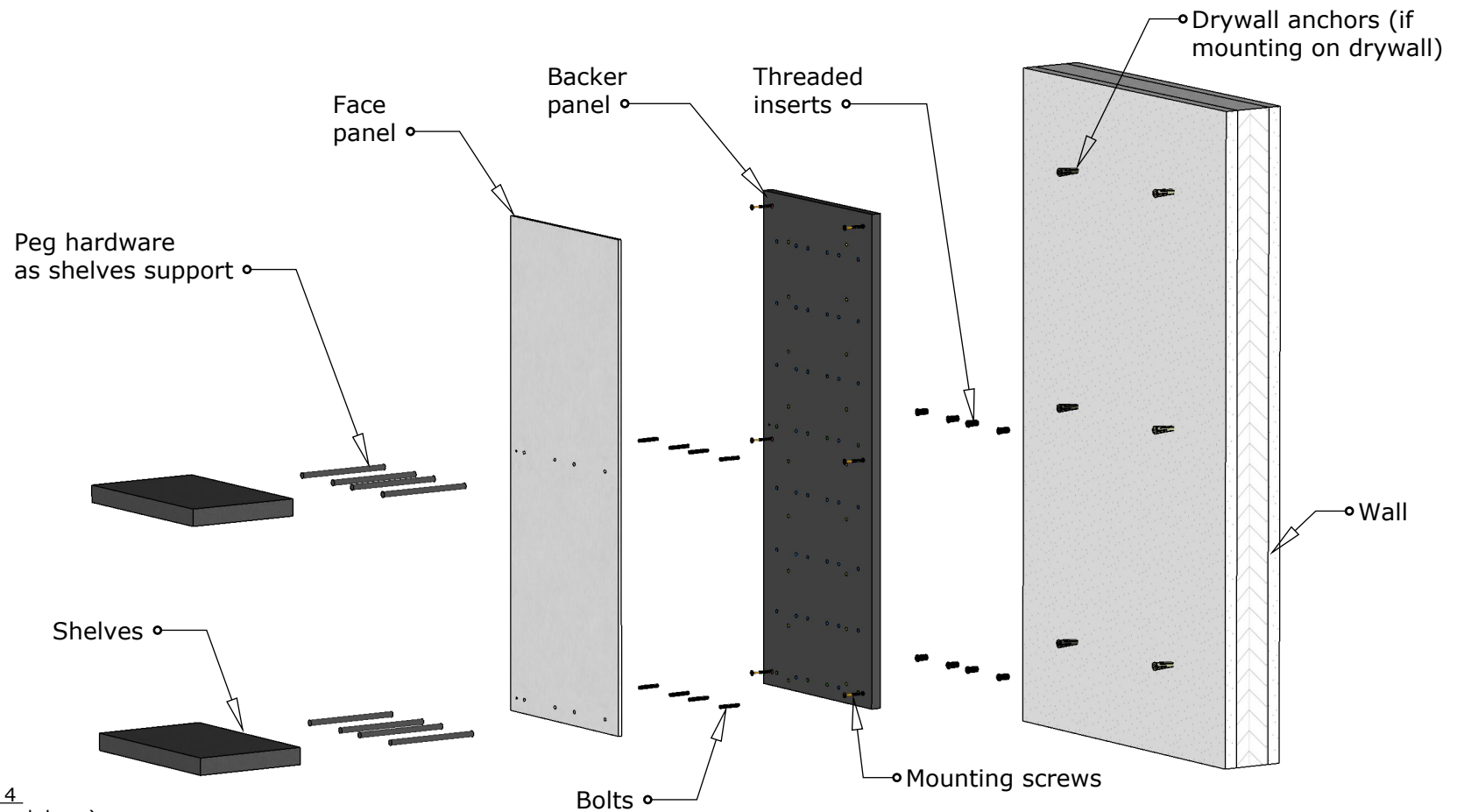

VINdustry Wine Pegs & Panel Kits

Rectangular panel Floating Shelves installation

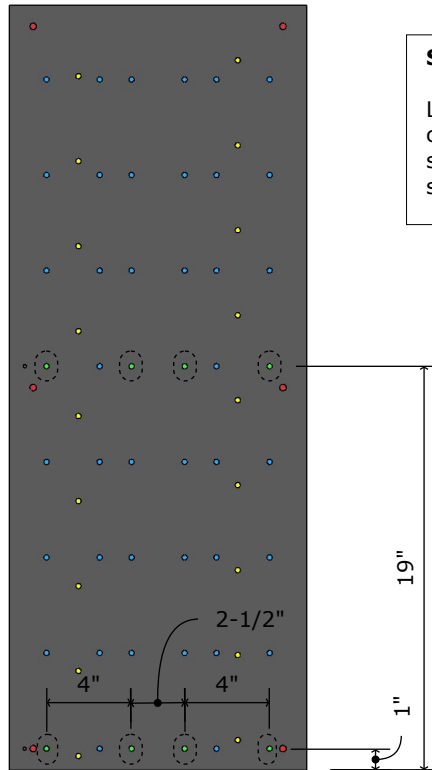

Step 1

Locate 8 holes for cork forward pegs as shown in green with spacing indicated

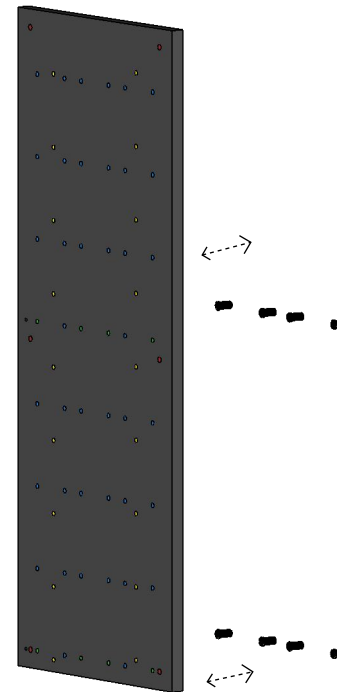

Step 2

Place 48 threaded inserts into the appropriate holes in back panel. Holes may be tight, use a rubber mallet

VINdustrial Wine Pegs & Panel Kits

Rectangular panel Floating Shelves installation

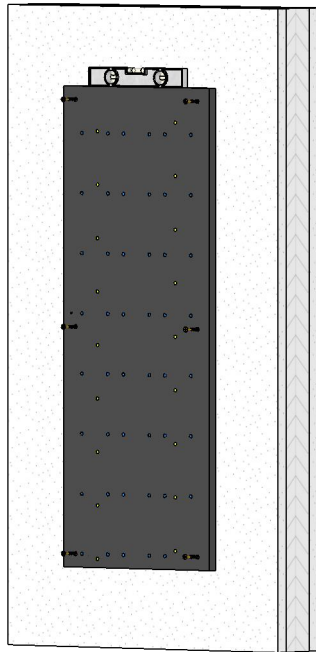

Step 3

Mount the back panel using predrilled mounting holes, use a level to ensure level installation (make sure the side of the panel you placed the threaded inserts into is facing the wall)
If using drywall anchors, install them first on the wall in locations corresponding with predrilled mounting holes on the panel

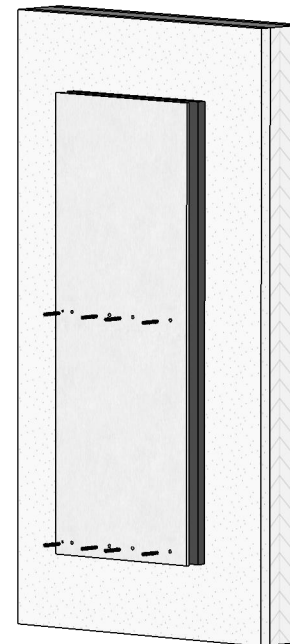

Step 4

Screw 8 bolts into threaded inserts and the fit face panel over (make sure the bolts screw fully into inserts)

VINdustry Wine Pegs & Panel Kits

Rectangular panel Floating Shelves installation

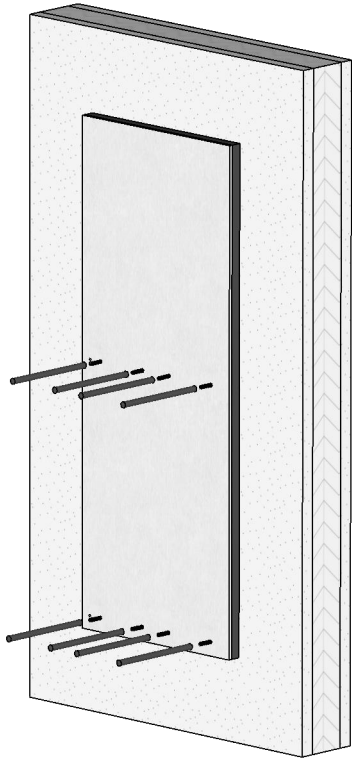

Step 5

Screw 8 pegs onto bolts (screw pegs fully onto bolts for a tight fit and strong hold) Use 6 double sided sticker dots provided for the top portion of the panel

PG. 4 of 4
(installation)

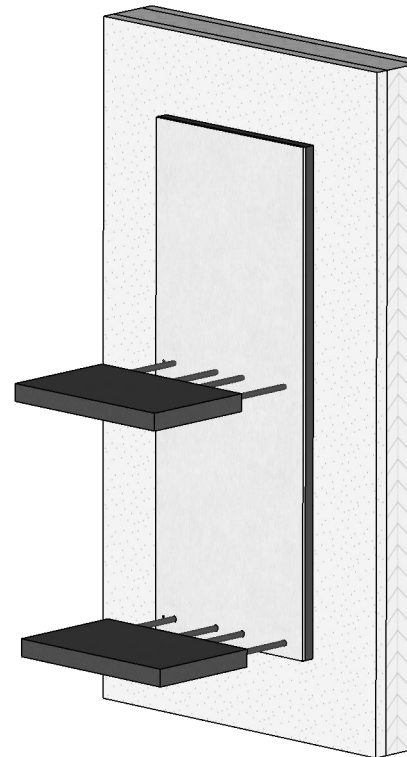

Step 6

Slide shelves onto pegs (make sure the holes in the shelves are aligned with pegs, slowly push the shelves in)

If installing LED light tape in the shelves fish the wire through pre-drilled holes in the shelves/face panel/backer panel